

**DIE ALIGN**



The Original  
**GORILLAGRIP**

**Power Pallet**



**World's Strongest**



**Quick Die Change  
Systems**



**Quality, Reliability and Value - Built into an  
American Made Product, Backed by a 4-Year Warranty**

**Pacesetter Systems**

25315 Ave. Stanford  
Valencia, CA 91355

Toll Free: 866-EZSETUP (397-3887)

(661)-295-8941

Fax: 661-295-8943

[www.pacesettersystems.com](http://www.pacesettersystems.com)

The Original  
**AIRGLIDE**  
Heavy Lift Pneumatic Die Lifters

The Original  
**HYDRAGLIDE**  
Hydraulic Die Lifters



***Die Lifting Rails***  
***Page 8***



***Hardware and  
Accessories***  
***Page 16-18***



***Hydraulic Clamps***  
***Page 23***

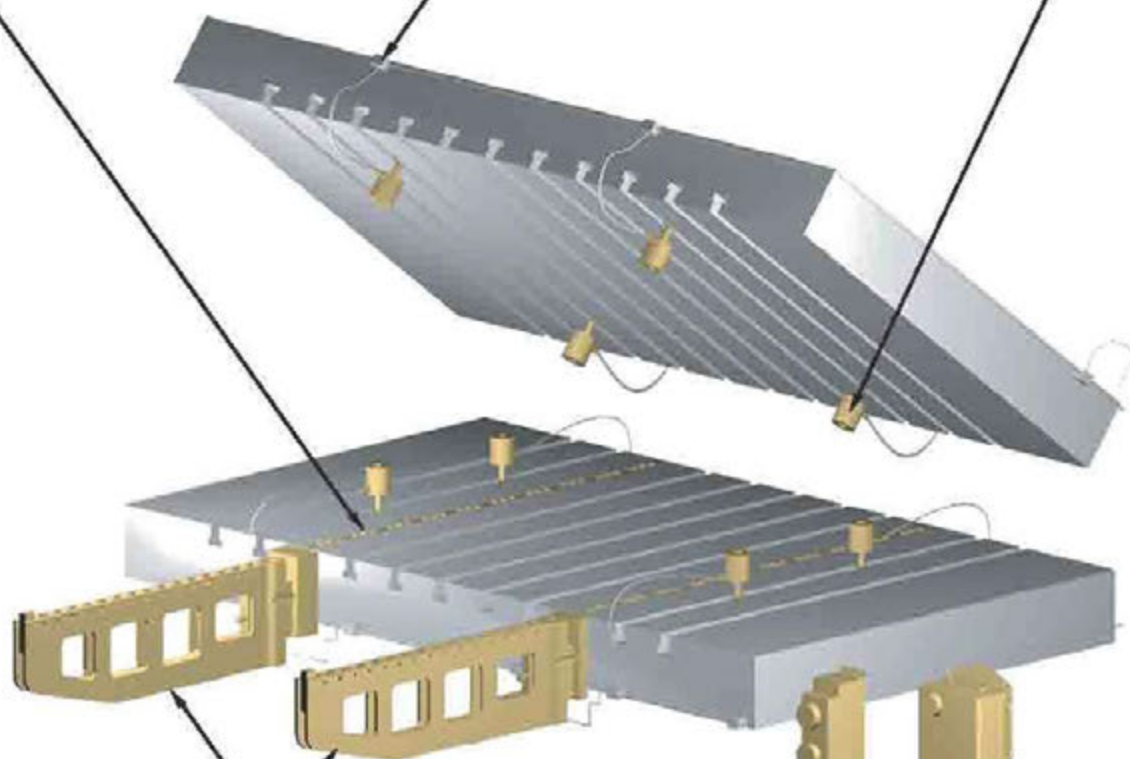

***Bolster Extensions***  
***Page 14***



***Controllers***  
***Page 20***



***Power Supplies***  
***Page 20***



# Table of Contents

Pacesetter Systems • Toll Free: 866-EZSETUP • [www.pacesettersystems.com](http://www.pacesettersystems.com)

<b>Introduction</b>	<b>Page</b>
Quick Die Change Return on Investment.....	4
Methods of Die Standardization.....	5
Available Clamp Locking Safety Systems.....	6
Selecting Appropriate Clamps and Die Lifters.....	7
<b>Die Lifters/Rollers</b>	
AirGlide™ Pneumatic Die Lifters.....	8
HydraGlide™ Hydraulic Die Lifters.....	9
Spring Powered Cartridges.....	12
Spring Powered Die Lifters.....	13
<b>Die Transfer Equipment</b>	
Die Transfer Rails.....	10
Die Roller Table Tops.....	11
Bolster Extensions.....	14
Power Pallet (Push/Pull Die Loading System).....	19
Die-Align™ (Premium Die Positioner).....	19
<b>Accessories</b>	
Die Standardization Accessories.....	16
Accessories.....	17
<b>Power Supplies &amp; Controllers</b>	
Pneumatic Switch (Air Control Valve).....	18
Air-Driven Hydraulic Power Supply.....	20
Controllers.....	20
<b>Clamps</b>	
GorillaGrip™ Adjustable Hydraulic Rocker Clamps.....	21
GorillaGrip™ Hydraulic Rocker Clamps.....	22
Gorilla Grip™ Hydraulic Cylinder Clamps.....	23
GorillaGrip™ Hydraulic Ledge Clamp.....	24
Mechanical Rocker Clamp.....	25
Diesetter™ Mechanical Clamps.....	26

# Return On Investment for a QDC System

Pacesetter Systems • Toll Free: 866-EZSETUP • [www.pacesettersystems.com](http://www.pacesettersystems.com)

Much has been written in the past about the benefits of a quick die change system. Speed, safety and labor cost reductions are all significant factors in considering whether a QDC system is right for your shop. However, in today's competitive business environment, the factor shop owners consider most is return on investment or ROI. That is, when will a QDC system pay for itself and begin to pay dividends for their business?

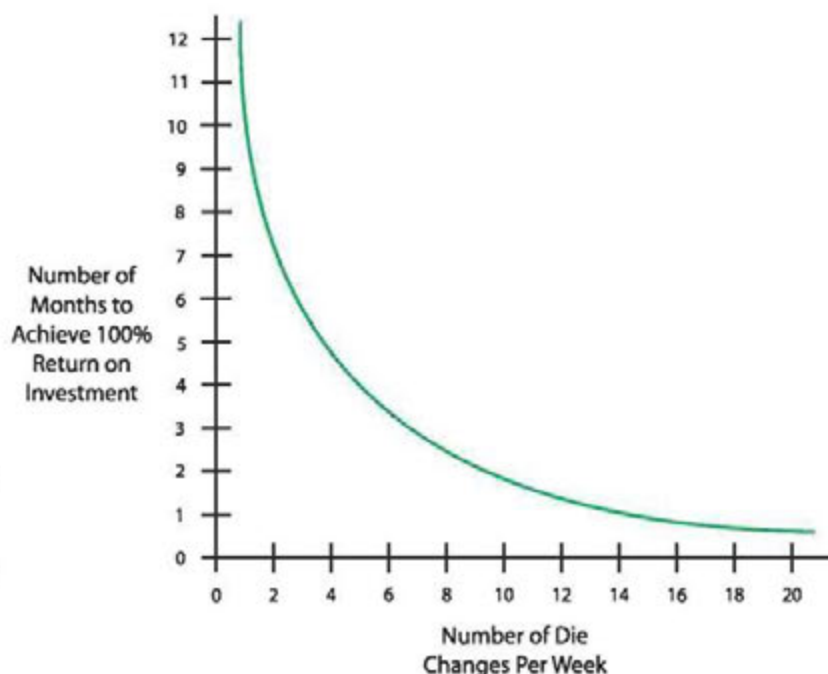

Unfortunately, there is no simple answer to that question, as each business is unique and each will have different results. But one thing is clear, the more often you change dies, the more you need a QDC system and the faster that system will pay for itself.

The graph above illustrates this point. The graph assumes a \$100 savings per die change related to reduced machine down time and fewer labor hours per die change. Most shops save much more than that and these assumptions do not include cost avoidance and ancillary benefits, which further increase the savings, but would require a dissertation from an accountant to explain. Nobody wants to read that!

So what is the bottom line? Based on just two dies changes per week, a QDC system can pay for itself in as little as 6 months and the more die changes you make, the sooner the system begins adding to your bottom line. It's that simple. As you can see, even with these conservative assumptions, the return on investment for a QDC system can be quite impressive.

If you're looking for ways to streamline your operation, a QDC system may be just what you've been looking for. And, if you're looking for the world's strongest QDC system that's 100% Made in USA and backed by an industry-leading warranty, look no further than Pacesetter Systems.



# Methods of Die Standardization

Pacesetter Systems • Toll Free: 866-EZSETUP • [www.pacesettersystems.com](http://www.pacesettersystems.com)

Proper die standardization is the cornerstone of any QDC system. The goal is to create the same clamping "footprint" on each of your die sets. By standardizing your die sets, you eliminate the need to move or readjust clamps when one die set is removed and another loaded onto the press. The methods of die standardization are outlined below.

## Solid Sub-Plates with Fixed Footprint

All die sets are attached to plates of equal dimension

- Provides continuous surface under die set for rolling elements, locating and support
- Provides uniform height of grip ledges
- Allows constant footprint to interface with fixed location clamps
- Eliminates need for T-slots if clamps are in fixed locations

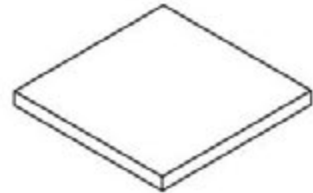

## Solid Sub-Plates with Random Footprint

Die sets are attached to sub plates of equal height, but unequal width and length

- Provides continuous surface under die set for rolling elements, locating and support
- Provides uniform height of grip ledges
- Provides best economy for sub-plate to die set size selection

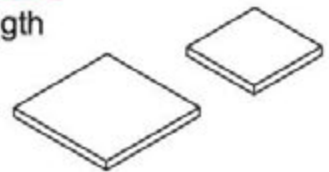

## Milled U-slots or Ledges

U-slots or ledges of equal size are milled into the die sets

- Modifications to existing die sets to create common grip
- Achieves die standardization without additional hardware

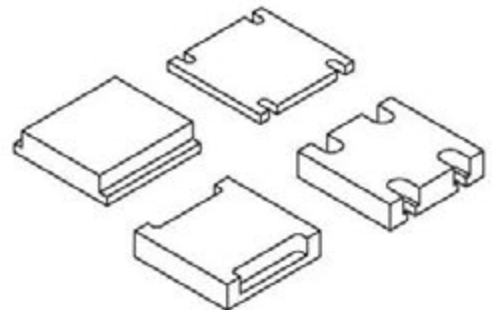

## Easy-Add Flanges from Pacesetter Systems

Our Easy-Add flanges are the quickest, most cost-effective route to die standardization

- Can be bolted or welded onto dies
- Quickest route to complete die standardization
- Provides consistent clamping surface
- Economical alternative to milling die sets
- High-quality steel for reliable clamping

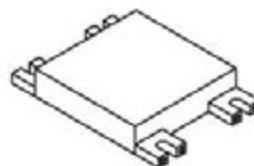

Die with Easy-Add U-Slot Flange

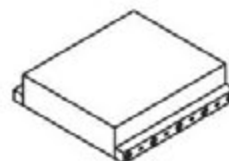

Die with Easy-Add Ledge Flange

# Available Clamp Locking Safety Systems

Pacesetter Systems • Toll Free: 866-EZSETUP • [www.pacesettersystems.com](http://www.pacesettersystems.com)

## Redundant Circuits

A redundant circuit setup uses four or more clamps on the bolster and ram, with two separate hydraulic circuits each powering half of the clamps. The system is configured so that clamps on opposite corners are powered by the same circuit. If hydraulic pressure is lost in circuit #1, the dies will be held in place by the clamps powered by circuit #2.

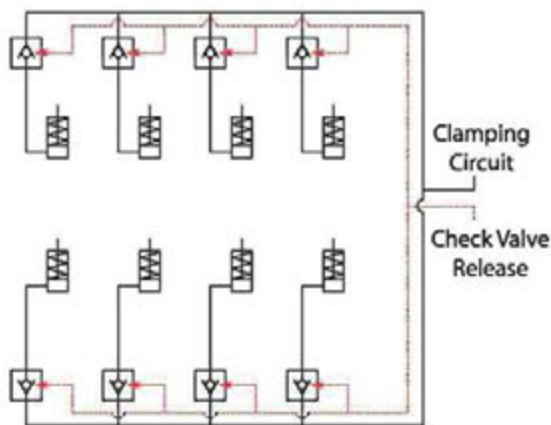
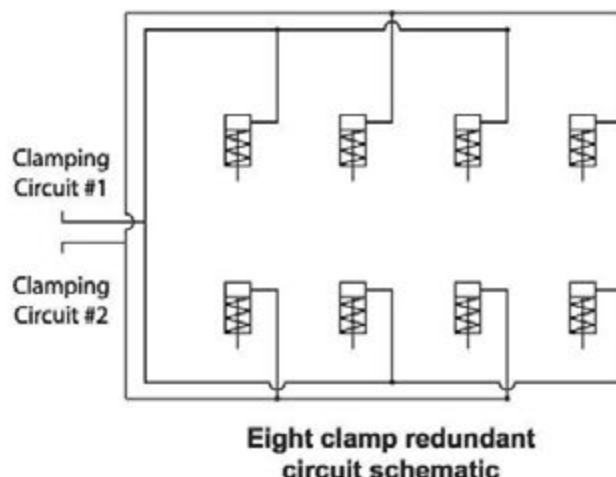

Schematic for clamping system with hydraulic check valves

## Hydraulic Check Valves

Our hydraulic clamping systems can be configured with our Model 180 check valve, which prevents pressure loss at the clamps if system pressure is lost. In addition, if pressure is lost at one clamp, the remaining clamps will not be affected. Check valves are pilot operated and can be configured to release automatically when system pressure is turned off or connected to a separate valve to be released manually, for added safety.

## Mechanical Locks

Most Pacesetter Systems hydraulic clamps are available with optional mechanical locks. Once pressure is applied to the system, the mechanical lock can be set. When the mechanical lock is set, system pressure can be deliberately turned off and the load will stay securely in place.

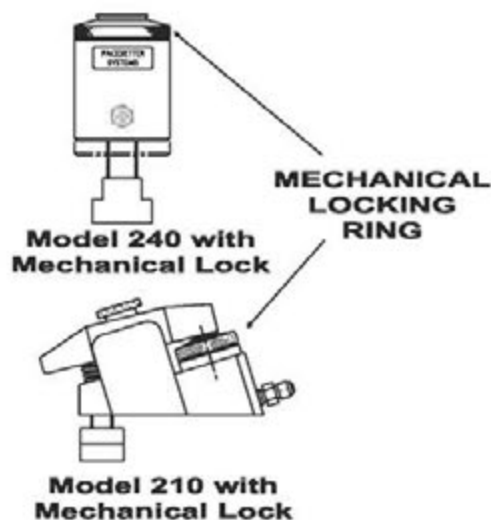



# Selecting the Appropriate Clamps and Lifters

Pacesetter Systems • Toll Free: 866-EZSETUP • [www.pacesettersystems.com](http://www.pacesettersystems.com)

## Clamp Selection\*

If your dies have ledge type flanges:

Then use any of the following clamps:



Models  
210, 220, 230



Models  
351, 352, 354



Model 360



Model 325



Model 71

If your dies have U-slot type flanges:

Then use any of the following clamps:



Models  
240, 241, 245, 260, 261,  
265, 280, 281, 285

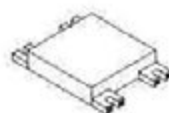

Model 70

## Die Lifter Selection\*

If your bolsters have T-slots:



Then use any of the following rails:



Air Glide  
Model 515



Hydra Glide  
Model 400



Spring Lift  
Model 510

If your bolsters have U-slots:



Then use any of the following rails:



AirGlide  
Model 516



Hydra Glide  
Model 401

\*Represents Standard Configurations. Other options are available per customer request.

# AirGlide™ Pneumatic Die Lifters

Pacesetter Systems • Toll Free: 866-EZSETUP • www.pacesettersystems.com

## Application

Air Glide Heavy Die Lifters are designed to provide ample lifting force in situations where hydraulic lifters are not preferable or available.



## Features

AirGlide die lifters feature high-quality o-ring seals and precision ground bearings for the ultimate in die moving efficiency. There are no bladders or air bags to puncture, pinch or deteriorate, making them the most reliable pneumatic die lifters in the industry.

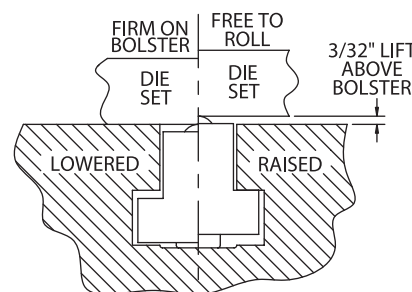

## Benefits

- Produces heavy lifting force with standard shop air pressure
- Available with ball or cylindrical bearings
- Installs easily in standard ANSI T-slots or U-slots
- Precision ground bearings for long life and effortless movement
- Available from stock in 6" increments up to 120"
- Custom and metric sizes available for any application per customer request

T-Slot Selection Table

AirGlide™ Rails	Nominal T-slot Size	Ball Bearing Max. Load Lbs./Ft.	Cylindrical Bearing Max. Load Lbs./Ft.
515-5/8" T-slot	5/8"	800	N/A
515-3/4" T-slot	3/4"	800	1,000
515-1" T-slot	1"	1,000	1,000

U-Slot Selection Table

AirGlide™ Rails	Nominal U-slot Size	Ball Bearing Max. Load Lbs./Ft.	Cylindrical Bearing Max. Load Lbs./Ft.
516-1 1/4" U-slot	1 1/4"	800	N/A
516-1 3/8" U-slot	1 3/8"	1,000	1,000

\* For Use With: Model 105D Air Control Valve Kit (page 18)

Model A170 Pneumatic Pressure Switch (page 17)



# HydraGlide™ Hydraulic Die Lifters

Pacesetter Systems • Toll Free: 866-EZSETUP • www.pacesettersystems.com



## Application

For use when maximum lifting power is required. Designed to fit in existing T-slots or U-slots with a wide range of carrying capacities available

## Features

Available with cylindrical or ball bearings. Precision ground bearings for long life and effortless die movement. Available in standard and custom sizes.

## Benefits

- Available with ball or cylindrical bearings
- Produces maximum lifting force for the heaviest loads
- Installs easily in standard ANSI T-slots or U-slots
- Precision ground bearings for long life and effortless movement
- Available in standard and custom lengths
- Custom and metric sizes available for any application per customer request

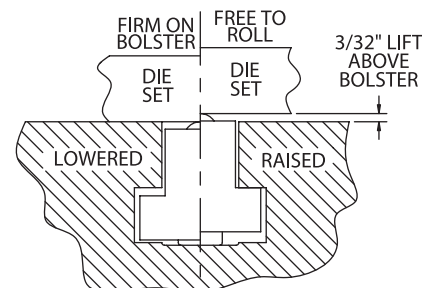

T-Slot Selection Table

HydraGlide™ Model Number	Nominal T-slot Size	Ball Bearing Max. Load Lbs./Ft.	Cylindrical Bearing Max. Load Lbs./Ft.
400-5/8" T-slot	5/8"	800	N/A
400-3/4" T-slot	3/4"	800	2,000
400-1" T-slot	1"	1,000	2,000
400-1" HD	1"	1,200	2,600
400-1 1/8" T-slot	1 1/8"	1,200	2,600
400-1 1/4" T-slot	1 1/4"	1,200	2,600

U-Slot Selection Table

HydraGlide™ Model Number	Nominal U-slot Size	Ball Bearing Max. Load Lbs./Ft.	Cylindrical Bearing Max. Load Lbs./Ft.
401-3/4" U-slot	3/4"	800	2,000
401-1" U-slot	1"	1,000	2,600
401-1 3/4" U-slot	1 3/4"	1,400	2,800
401-2" U-slot	2"	1,400	2,800

\* For Use With: Power Supply (page 20) and Installation Kit.

# Transfer Rails

Pacesetter Systems • Toll Free: 866-EZSETUP • [www.pacesettersystems.com](http://www.pacesettersystems.com)

## Application

Provides quick and easy movement of dies from the press to the storage or staging area. Excellent alternative to expensive die carts.

## Features

Available with cylindrical or ball bearings. Both styles can be ordered with high-density bearing surface for maximum load carrying capacity.

## Benefits

- Able to support the heaviest dies
- Cylindrical or ball bearings
- Installs easily on storage racks and transfer carts
- Precision ground bearings for long life and effortless movement
- Custom sizes available for any application per customer request

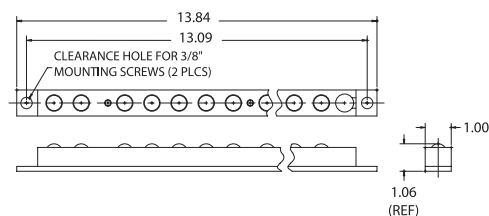
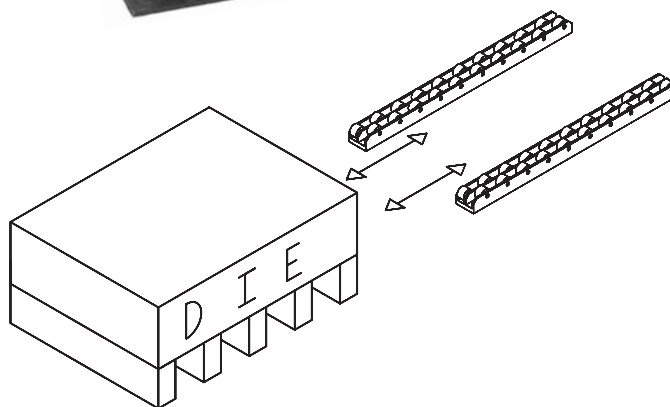

Model 530 Spherical Bearing

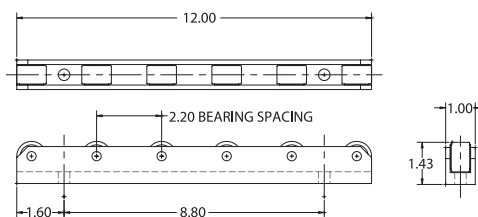

Model 531 Cylindrical Bearing

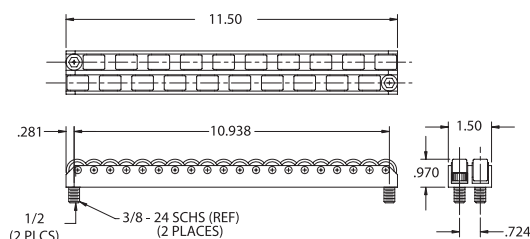

Model 532 High-Density Cylindrical Bearing

Model No.	Transfer Rail Type	Max. Load lbs./ft.
530	Spherical Bearing	1,200
533	High Density Spherical Bearing	2,400
531	Cylindrical Bearing	2,000
532	High-Density Cylindrical Bearing	3,000



# Die Roller Table Tops

Pacesetter Systems • Toll Free: 866-EZSETUP • [www.pacesettersystems.com](http://www.pacesettersystems.com)



## Application

Designed for easy staging of dies during die changeover. Economical alternative to expensive die carts. Can handle die weights up to 1,800 lbs. per square foot.

## Features

High-quality, precision ground chrome ball bearings for easy die movement in any direction. Heavy-duty rollers for a lifetime of reliability.

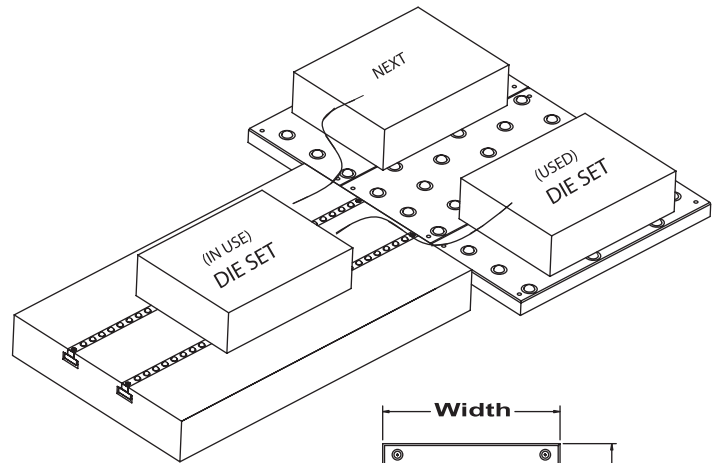

## Benefits

- Easy pre and post staging of dies
- Economical alternative to expensive die carts
- Precision ground bearings for effortless die movement
- Die weights up to 1,800 lbs. per square foot

Model No.	Length	Width	Height	Capacity Lbs./Sq. Ft.
520-2	24"	2"	1.13"	1,800
520-8	24"	8"	1.13"	1,800
520-12	24"	12"	1.13"	1,800
520-36	24"	36"	1.13"	1,800
520-36X36	36"	36"	1.13"	1,800

# Insertable Spring Lift Cartridges

Pacesetter Systems • Toll Free: 866-EZSETUP • [www.pacesettersystems.com](http://www.pacesettersystems.com)



Model 505

## Application

For use when T-slots are not available. Cost-effective alternative to expensive T-slot machining. Excellent for use where hydraulic systems are not available or not desirable.

## Features

Precision ground chrome bearings for effortless die movement in any direction. Easy retrofit to bolsters, with only simple drilling tools required. Available in four sizes to meet any die moving application. Easy installation and removal, without special tools.

## Benefits

- Precision-ground bearings for ultra smooth rolling
- Extra-large bearings for maximum load capacity
- Perfect for applications where T-slots are not available
- Available in 3/4", 1", 1 3/16" and 1 5/8" sizes
- Permits die movement in all directions
- Installs easily in standard-size drilled holes - no special flat-bottom required
- Install and remove without special tools

Spring Lift Cartridges 505 Series	Maximum Load (Lbs./Each Roller)	Hole Dia. (-.000"/+.010")	Hole Depth (±.005")	Alternate Flat-Bottom Hole Depth (±.005")
505-3/4"	45	.750"	0.990"	1.010"
505-1"	75	1.00"	1.110"	1.130"
505-1 3/16"	120	1.187"	1.355"	1.375"
505-1 5/8"	210	1.625"	1.750"	1.770"



# Spring Lift Rails

Pacesetter Systems • Toll Free: 866-EZSETUP • [www.pacesettersystems.com](http://www.pacesettersystems.com)

## Application

Excellent for use where hydraulic systems are not available or not desirable. Designed for easy installation and hassle-free performance.



Model 510

## Features

Precision ground chrome steel bearings for effortless die movement in any direction. Available in three sizes for installation in standard T-slots or U-slots. Easy installation and removal, without special tools.

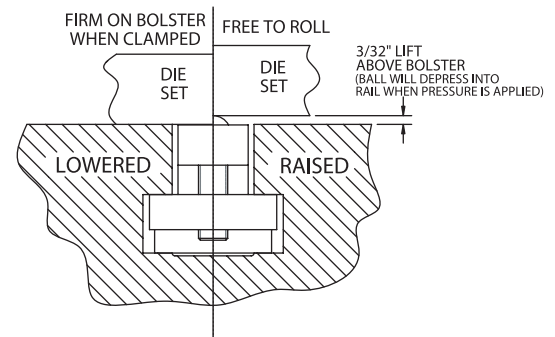

## Benefits

- Installs in minutes
- Precision-ground bearings for ultra smooth rolling
- Heavy duty springs for maximum load capacity
- Perfect for applications where hydraulic systems are not available or desirable
- Available for 5/8", 3/4" and 1" T-slots or U-slots
- Permits die movement in all directions
- Available in lengths from 6" to 96"

Spring Lift Rails 510 Series	Nominal T-slot Size	Max. Load lbs./ft.
10", 12" & 18"	5/8"	550
10", 12" & 18"	3/4"	550
10", 12" & 18"	1"	750

# Bolster Extensions

Pacesetter Systems • Toll Free: 866-EZSETUP • [www.pacesettersystems.com](http://www.pacesettersystems.com)



## Application

Easily load and unload dies that do not have risers. Our 48" Bolster Extensions are the strongest in the industry, handling loads up to 16,000 lbs., without the need for support legs.

## Benefits

- Installs easily between or in-line with T-slots
- Precision ground bearings for easy movement
- Share lift-off models between presses
- Folding models fold flush against press
- Custom lengths available on request
- Designed with 3/32" roller lift to align with bolster die lifters

## Features

Available in lift-off or folding models. High-quality precision ground bearings for reliability and easy die movement. Available from stock in a wide variety of sizes, with custom sizes available on request.

Locate holes for your bolster extensions quickly and accurately with our Precision Drill Fixture (page 18).

Load Lbs./Pair.	Die Resting Length	Lift Off Model No.	Length	Height	Minimum Bolster Thickness	Folding Model No.	Length	Height	Minimum Bolster Thickness
6,000	15"	549L-15	15"	6"	4.5"	---	---	---	---
	19"	549L-19	19"	6"	4.5"	549F-19	19"	6"	4.0"
	23"	549L-23	23"	6"	4.5"	549F-23	23"	6"	4.0"
	27"	549L-27	27"	8"	6.5"	549F-27	27"	6"	4.0"
	31"	549L-31	31"	8"	6.5"	549F-31	31"	8"	4.0"
	35"	---	---	---	---	549F-35	35"	8"	4.5"
	36"	---	---	---	---	549F-36	36"	10"	6.0"
	37"	549L-37	37"	10"	7.8"	---	---	---	---
	42"	---	---	---	---	549F-42	42"	10"	6.0"
	43"	549L-43	43"	10"	7.8"	---	---	---	---
10,000	48"	549L-48	48"	10"	7.8"	549F-48	48"	10"	6.0"
	15"	550L-15	15"	6"	4.5"	---	---	---	---
	19"	550L-19	19"	6"	4.5"	550F-19	19"	6"	4.0"
	23"	550L-23	23"	6"	4.5"	550F-23	23"	6"	4.0"
	27"	550L-27	27"	8"	6.5"	550F-27	27"	6"	4.0"
	31"	550L-31	31"	8"	6.5"	550F-31	31"	8"	4.5"
	35"	---	---	---	---	550F-35	35"	8"	4.5"
	36"	---	---	---	---	550F-36	36"	10"	6.0"
	37"	550L-37	37"	10"	7.8"	---	---	---	---
	42"	N/A	N/A	N/A	N/A	550F-42	42"	10"	6.0"
16,000	43"	550L-43	43"	10"	7.8"	---	---	---	---
	48"	550L-48	48"	10"	7.8"	550F-48	48"	10"	6.0"
	31"	552L-31	31"	10"	7.8"	---	---	---	---
	36"	---	---	---	---	552F-36	36"	10"	6.0"
	37"	552L-37	37"	10"	7.8"	---	---	---	---
	42"	---	---	---	---	552F-42	42"	10"	6.0"
	43"	552L-43	43"	10"	7.8"	---	---	---	---
	48"	552L-48	48"	10"	7.8"	552F-48	48"	10"	6.0"



# Quotation Request

Fax to: 661-295-8943

## General Information

Company Name: \_\_\_\_\_  
Contact: \_\_\_\_\_ Title: \_\_\_\_\_  
Address: \_\_\_\_\_  
Phone: \_\_\_\_\_ Ext: \_\_\_\_\_ Fax: \_\_\_\_\_ Email: \_\_\_\_\_

## Press Information

Manufacturer and Model: \_\_\_\_\_  
Press Type: ☐ C-Frame ☐ Straight Side Tonnage: \_\_\_\_\_  
Bolster Dimensions: \_\_\_\_\_ (L-R) x \_\_\_\_\_ (F-B) x \_\_\_\_\_ Height  
Bolster T-Slots (How many): ☐ L-R ☐ F-B ☐ None  
Bolster T-Slot Dimensions: A \_\_\_\_\_ B \_\_\_\_\_ C \_\_\_\_\_ D \_\_\_\_\_ E \_\_\_\_\_  
Ram Dimensions: \_\_\_\_\_ (L-R) x \_\_\_\_\_ (F-B) x \_\_\_\_\_ Height  
Ram T-Slots (How many): ☐ L-R ☐ F-B ☐ None  
Ram T-Slot Dimensions: A \_\_\_\_\_ B \_\_\_\_\_ C \_\_\_\_\_ D \_\_\_\_\_ E \_\_\_\_\_  
Maximum Stripping Force: \_\_\_\_\_

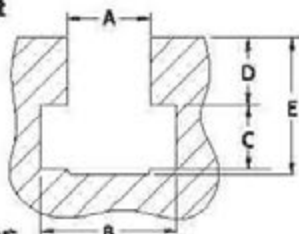

## Die Information

Maximum Total Weight: \_\_\_\_\_ Lbs. Upper: \_\_\_\_\_ Lbs. Lower: \_\_\_\_\_ Lbs.  
Die Dimensions: Max.: \_\_\_\_\_ L-R \_\_\_\_\_ F-B Min.: \_\_\_\_\_ L-R \_\_\_\_\_ F-B  
Clamping Ledge Height: Bolster \_\_\_\_\_ Ram \_\_\_\_\_  
Are Dies Slotted for Clamps? ☐ Yes ☐ No  
Number of bolts currently used to clamp dies: Bolster \_\_\_\_\_ Ram \_\_\_\_\_  
Dies Loaded From (check one): ☐ Left ☐ Right ☐ Front ☐ Back  
Dies Unloaded From (check one): ☐ Left ☐ Right ☐ Front ☐ Back

## Die Transfer & Alignment Equipment

Power Pallet: ☐ Yes ☐ No  
Model 536 (6,000 lbs capacity): \_\_\_\_\_ Model 535 (3,000 lbs capacity): \_\_\_\_\_  
Die-Align (Die Positioner): ☐ Yes ☐ No Number of Sets? \_\_\_\_\_

## Clamping Information

Type of Clamps Preferred (check one): Then, select Type of Lock Preferred:  
☐ Hydraulic Rocker Clamps ☐ Manual Lock ☐ Hyd. Check Valve ☐ Fully Hydraulic  
☐ Adj. Hyd. Rocker Clamps ☐ Manual Lock ☐ Hyd. Check Valve ☐ Fully Hydraulic  
☐ Hyd. Ledge Clamps ☐ Manual Lock ☐ Hyd. Check Valve ☐ Fully Hydraulic  
☐ Hydraulic Cylinder Clamps ☐ Manual Lock ☐ Hyd. Check Valve ☐ Fully Hydraulic  
☐ Mechanical Clamps

## Die Lifter Information

Type of Die Lifters Preferred (check one): Then, select Type of Bearings Preferred:  
☐ Hydraulic Lift ☐ Ball Type (Spherical) ☐ Cylinder Type  
☐ Pneumatic Lift ☐ Ball Type (Spherical) ☐ Cylinder Type  
☐ Spring Lift

## Bolster Extensions

☐ Lift-off Type ☐ Folding Type ☐ Length \_\_\_\_\_

## Hydraulic Controls

☐ Manual 2-Position Valve ☐ Electric Switch



# Accessories

Pacesetter Systems • Toll Free: 866-EZSETUP • [www.pacesettersystems.com](http://www.pacesettersystems.com)

## Easy-Add U-Flange

Model 626

- For use with Diesetter mechanical clamps or hydraulic cylinder clamps
- Can be bolted or welded onto dies
- Precision machined high strength steel

## Easy-Add Ledge Flange

Model 602

- For use with Diesetter mechanical clamps or hydraulic rocker clamps
- Can be bolted or welded onto dies
- Custom lengths for any size dies

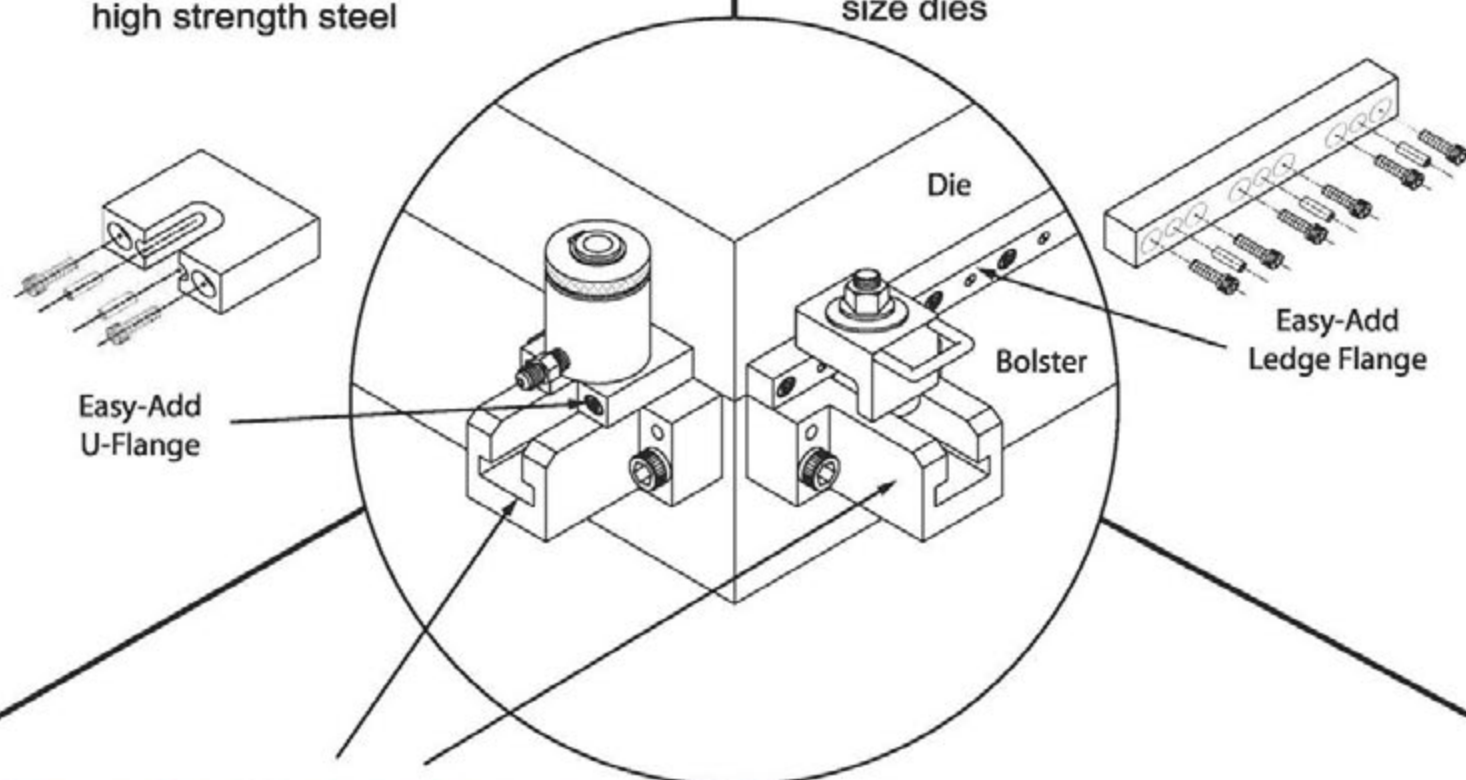

## T-slot Extenders

Model 601

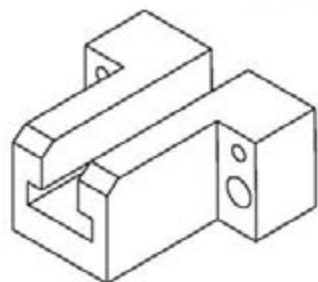

- Increases usable bolster and ram surface
- Clamps can be used beyond bolster or ram edge
- Allows bolster or ram mounted clamps to be moved out of the way during die change



# Accessories

Pacesetter Systems • Toll Free: 866-EZSETUP • [www.pacesettersystems.com](http://www.pacesettersystems.com)



**Hydraulic Pump  
Model P71**

Air/oil hydraulic pump with 6,000 psi. standard operating pressure.



**Hose Making Kit  
Model 620**

Everything you need to make custom length high pressure hydraulic hoses. Crimping tool is powered by the same Pacesetter Systems power supply operating clamps and lifters.



**4-way Valve  
P/N 10158**

Directional fluid control valve to control fluid flow to hydraulic clamps and lifters. Metal-to-metal seals with zero internal leakage at 6,000 psi.



**Hose Making Refill Kit  
Model K620**

Everything you need to restock your hose making kit. Includes hose and hardware.

**Pressure  
Switch**



**Model 170  
(for hydraulic)**

**Model A170  
(for pneumatic)**

Monitors system pressure or individual circuit pressure and stops press if pressure drops below prescribed levels.

**Shown with Anti-Kink feature.  
Model 625-AK**



**Pre-made hydraulic hoses  
Model 625, or 624-(Large Size)**

Available in a wide variety of sizes from stock or custom made to your specifications.



**Hydraulic Hose Quick Disconnect  
Model 649**

Allows you to quickly disconnect the hydraulic lines once your clamps are clamped and mechanically locked to prevent them from being inadvertently damaged by the press.



**Junction Blocks  
P/N PS-102**

Route your hydraulic lines any way you please with our versatile junction blocks. More than 30 configurations available. Contact us for a complete list.

# Accessories

Pacesetter Systems • Toll Free: 866-EZSETUP • [www.pacesettersystems.com](http://www.pacesettersystems.com)



**Check Valve  
Model 180**

Pilot operated safety valve prevents clamps from releasing if system pressure is lost.



**Pneumatic Switch  
Model 105-D**

Controls air pressure to AirGlide Heavy Lift pneumatic die lifters. Raises and lowers lifters with the flick of a switch.



**Hydraulic Oil  
Model 630**

Premium grade hydraulic oil for HydraGlide rails and Gorilla Grip clamps.



**Lift-off Bolster Extension Brackets  
Model 603**

Mount on side of bolster to attach lift-off type bolster extensions.



**Drilling and Tapping Fixture  
Model T-252**

For precisely locating and tapping bolster extension mounting holes. Made from high quality steel with heat-treated steel bushings.



**Clamp Parking Brackets  
P/N 4041-1**

Hang clamps out of the way during die change on our sturdy parking brackets.



**T-Nuts**

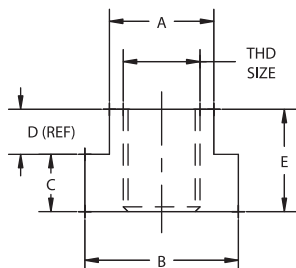

Nominal T-Bolt Size	Thread Size	Part Number	"A"	"B"	"C"	"D"	"E"
5/8"	5/8"-11	6655	.67	1.13	.44	.31	.75
3/4"	3/4"-10	6656	.80	1.25	.56	.19	.75
1"	3/4"-10	6658-2	1.05	1.75	.75	.50	1.25
1"	7/8"-9	6657-1	1.00	1.75	.75	.50	1.25
1"	7/8"-9	6657	1.05	1.75	.75	.50	1.25
1"	1"-14	6658	1.05	1.75	.75	.50	1.25

High surface area T-nuts provide maximum holding power.  
Available with tapped-through or non-tapped-through threads.



# **Power Pallet** **Push/Pull Die Loading System**

## **Application**

The Power Pallet is the ultimate efficient die loading system that eliminates the need for die carts and increases safety more than ever before. It's designed to attach to any standard forklift.

## **Features**

Powered by a rechargeable battery that's good for 12 die changes, the Power Pallet can load/unload dies with just the push of a button, and at various speeds. It features rails that easily latch on to pins pre-installed on dies, and then can either push or pull with the turn of a built-in gear switcher. Also comes with brackets that mount on the front of bolster for the purpose of easydocking action with the pallet. Includes our world-famous pneumatic die lifters for smooth die gliding action.

## **Benefits**

- Relatively small size makes it easy to store, no more need for die carts
- Able to load/unload up to 6,000 lbs load capacity in die weight
- Simple push/pull design reduces the risk of injury and strain on your workforce

Pacesetter Systems • Toll Free: 866-EZSETUP • [www.pacesettersystems.com](http://www.pacesettersystems.com)



Model 536-6,000 lbs capacity  
Model 535-3,000 lbs capacity



**Call for a free  
demonstrational DVD**

## **Die-Align™**

**Totally eliminates manual alignment  
when used with the Power Pallet**

This innovative tool makes it easy to accurately locate and center any die on your press. The V-Block mounts on the back of the die shoe and guides it left to right, and front to back around a pin (1-inch diameter) that's installed in the bolster. The stop block rests on the other side of the die and helps square it evenly on the press. Die-Align is designed to align a die of any size.

Model 631

V-Block



Stop-Block





# Power Supplies and Controllers

Pacesetter Systems • Toll Free: 866-EZSETUP • [www.pacesettersystems.com](http://www.pacesettersystems.com)



## Application

Air-driven hydraulic power supply for controlling and monitoring hydraulic circuits. Can be used with external controllers to operate a maximum of five circuits. Operates HydraGlide hydraulic die lifters and GorillaGrip hydraulic clamps.

## Features

Powered by normal shop air pressure (80-150 psi.), with no electrical requirements. Hydraulic pressure is controlled by an adjustable air regulator. System pressure is displayed by a full-range hydraulic pressure gauge. Hydraulic reservoir gauge to monitor hydraulic fluid levels.

## Benefits

- Contains no electrical components
- System pressure displayed by full-range hydraulic pressure gauge
- Hydraulic oil reservoir gage standard on all models
- Powered by normal shop air pressure

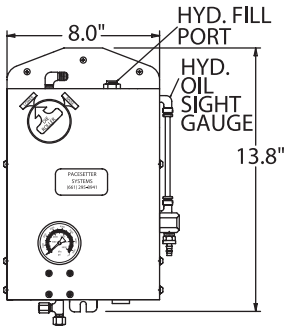

Model 110 Power Supply  
With Built-in Controller



### Two-Circuit Manual Controller

Control additional hydraulic circuits powered by a single power supply using our two-circuit manual controller. Up to two manual controllers can be added per power supply.



### Electronic Key Switch Controller (Four-Circuit shown)

For the ultimate in safety and security. Our key switch controller prevents accidental or unauthorized switching of hydraulic circuits.

Manual Controller Model Number	Electronic Controller Model Number	Circuits	Controllers Required
110	E-110	1	Integrated
120	E-120	2	1
130	E-130	3	1
140	E-140	4	2
150	E-150	5	2

# Gorilla Grip™ Adjustable Hydraulic Rocker Clamps

Pacesetter Systems • Toll Free: 866-EZSETUP • [www.pacesettersystems.com](http://www.pacesettersystems.com)



## Application

This extremely versatile clamp is designed for use with die ledges of inconsistent or varying thickness. Gorilla Grip adjustable clamps can be moved around the bolster easily, making them the ideal solution for shops using different sized dies on the same press.

## Features

Gorilla Grip adjustable rocker clamps are hydraulically assisted, allowing you to lock the load down tight. Once locked down, they will continue to grip with maximum force, even if the hydraulic system is disconnected.

## Benefits

- Available in three sizes
- Up to 15,000 lbs. clamping force
- Precision built for extreme reliability
- Hydraulic line can be removed after clamping
- Wide gripping range for ultimate versatility

Use with Power Supply  
(page 20) and Model 170  
Pressure Switch (page 17).

### Die Set Compatibility

Variable Thickness Grip Ledge

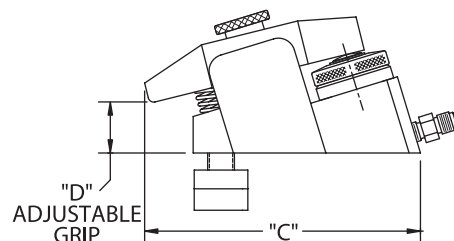
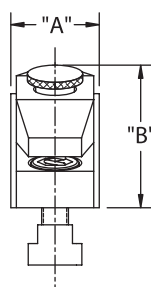
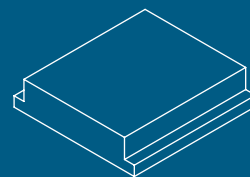

Model No.	Clamping Force @ 6,000 psi	Width "A"	Height "B"	Length "C"	Adjustable Grip "D"
210	4,000 lbs.	2.00"	3.34"	6.4"	0.75"-1.75"
220	10,000 lbs.	2.50"	5.00"	8.84"	0.75"-2.25"
230	15,000 lbs.	3.00"	6.10"	11.14"	1.00"-2.50"

# Gorilla Grip™ Hydraulic Rocker Clamps

Pacesetter Systems • Toll Free: 866-EZSETUP • [www.pacesettersystems.com](http://www.pacesettersystems.com)



## Application

Used for clamping dies with a uniform-height clamping ledge. The optimum configuration for applications requiring strong clamping force from a low-profile clamp. Excellent for shops with standardized ledge flange die sets.

## Features

Available in three sizes with clamping force up to 20,000 lbs. Precision built for extreme reliability. Easily move clamps around bolster to accommodate dies of varying sizes.



## Benefits

- Available in three sizes
- Up to 20,000 lbs. clamping force
- Precision built for extreme reliability
- Economical low-profile clamping solution
- Accommodates any die shoe thickness

Use with Power Supply (page 20) and Model 170 Pressure Switch (page 17).

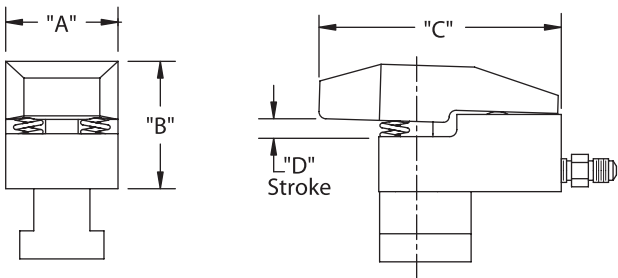

Model No.	Clamping Force @ 6,000 psi	Width "A"	Height "B"	Length "C"	Stroke "D"
351	5,000 lbs.	2.00"	2.27"	4.4"	0.75"-1.25"
352	10,000 lbs.	3.00"	2.27"	4.4"	0.75"-1.25"
354	20,000 lbs.	4.79"	2.87"	5.6"	1.00"-1.50"



# Gorilla Grip™ Hydraulic Cylinder Clamps

Pacesetter Systems • Toll Free: 866-EZSETUP • [www.pacesettersystems.com](http://www.pacesettersystems.com)



## Application

For use with slot-type die shoes with consistent height. Provides high clamping force with minimum space requirements.

## Features

Economical and versatile clamping system, with T-nut shaft or threaded shaft for easy installation. Available in full hydraulic and hydraulic assisted models.



## Benefits

- Up to 22,000 lbs. clamping force
- Precision built for extreme reliability
- Optional redundant hydraulic circuits for extra safety
- Available with or without mechanical safety locks

### Die Set Compatibility

Consistent Thickness Grip  
Ledge With Slots

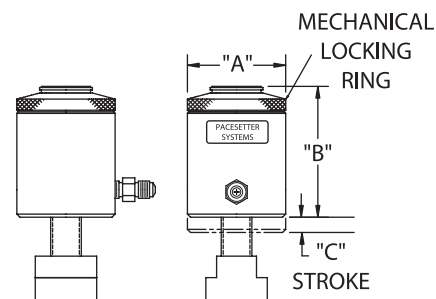
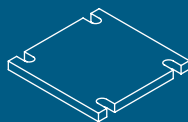

Models  
240/260/280

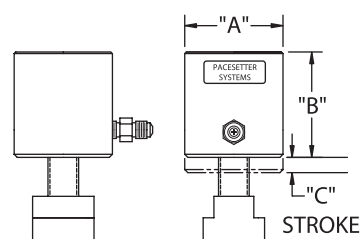

Models  
241/261/281

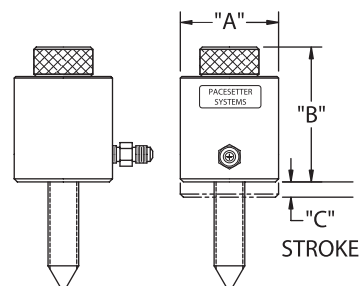

Models  
245/265/285

Clamping Force @ 6,000 PSI	Model No.	Installation	Mechanical Lock	Diameter "A"	Height "B"	Stroke "C"
9,000 lbs.	240	T-Nut	Yes	2.00"	2.62"	0.25"
	241	T-Nut	No	2.00"	2.10"	0.25"
	245	Threaded Shaft	No	2.00"	2.85"	0.25"
12,000 lbs.	260	T-Nut	Yes	2.50"	2.73"	0.31"
	261	T-Nut	No	2.50"	2.14"	0.31"
	265	Threaded Shaft	No	2.50"	2.96"	0.31"
22,000 lbs.	280	T-Nut	Yes	3.00"	3.81"	0.38"
	281	T-Nut	No	3.00"	2.88"	0.38"
	285	Threaded Shaft	No	3.00"	4.04"	0.38"

# Hydraulic Ledge Clamps

Pacesetter Systems • Toll Free: 866-EZSETUP • [www.pacesettersystems.com](http://www.pacesettersystems.com)



Model 360



## Benefits

- Up to 40,000 lbs. clamping force
- Low profile design
- Precision built for extreme reliability
- Complete "hands-free" operation
- Permanent or movable mounting options

## Application

For applications requiring maximum clamping force in low-profile unit. Optimum for clamping slide-in type dies with uniform clamping ledges. Mounts permanently to the bolster or ram, or in T-slots for use as a movable clamp.

## Features

Heavy-duty load holding capacity with up to 40,000 lbs. of clamping force. Precision built for extreme reliability. Complete hands-free operation with minimal die standardization required. Uses check valve or redundant circuits for safety.

### Die Set Compatibility

Consistent Thickness Grip

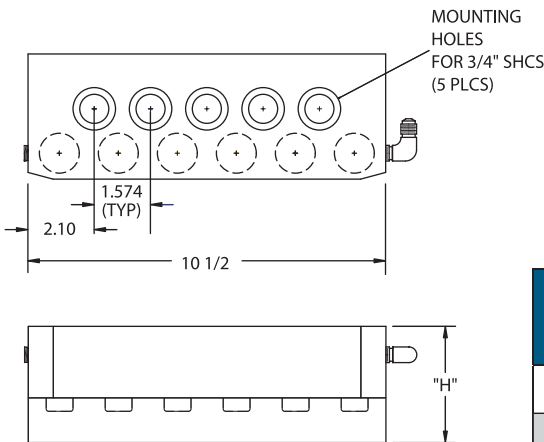
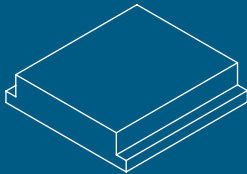

Use with Power Supply (page 20) and Model 170 Pressure Switch (page 17).

Part Number	Grip (min/max)	Height (H)
10452-1.25	1.00/1.25	3.38
10452-1.50	1.25/1.50	3.63
10452-1.75	1.50/1.75	3.88
10452-2.00	1.75/2.00	4.13

# Mechanical 1/4 Turn Rocker Clamps

Pacesetter Systems • Toll Free: 866-EZSETUP •

## Application

Use when a variety of gripping heights are needed from a mechanical clamp.  
Excellent alternative when mechanical clamping is preferred.

## Features

Accommodates a wide variety of ledge flange thickness. Clamps quickly and easily.  
Precision built for a lifetime of reliable, hassle-free operation.



4,000 lbs clamping force

## Benefits

- Quick and easy clamping
- Broad range of grip height
- Fits in standard ANSI T-slots
- Precision built for extreme reliability
- Economical alternative to hydraulic systems

### Die Set Compatibility

Variable Thickness Grip

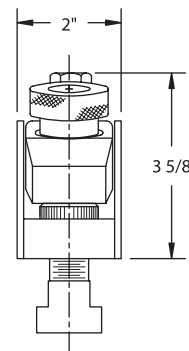
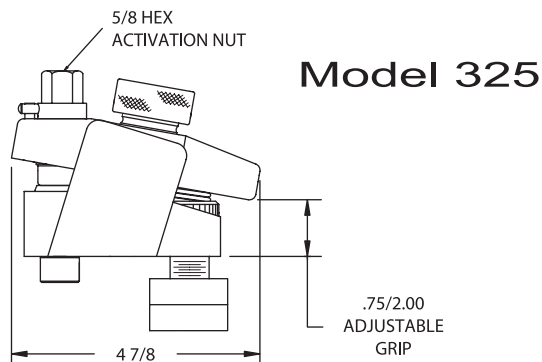
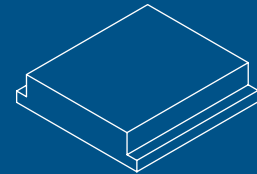



# Diesetter™ Mechanical Clamps

Pacesetter Systems • Toll Free: 866-EZSETUP • [www.pacesettersystems.com](http://www.pacesettersystems.com)



Model 70

Model 71

Two styles available for either U-flange or ledge-type dies.

## Benefits

- 1/8-turn clamping action
- Automatically positioned clamp arms for quick alignment with die set
- Precision-machined clamp arm surfaces provide increased surface contact for superior holding
- Up to 44,000 lb. load capacity
- Minimal die standardization
- Ergonomically designed handle for ease of use

## Application

For applications where hydraulic clamps are not preferable or available. Can be used with either U-flange or ledge-type flange die sets. Available in several sizes and configurations to handle a wide variety of die sizes.

## Features

Exclusive torque-reducing anti-friction thrust bearing, with 1/8 turn clamping action. Precision-machined clamp arm surfaces for superior holding. Ergonomically designed handle for ease of use.

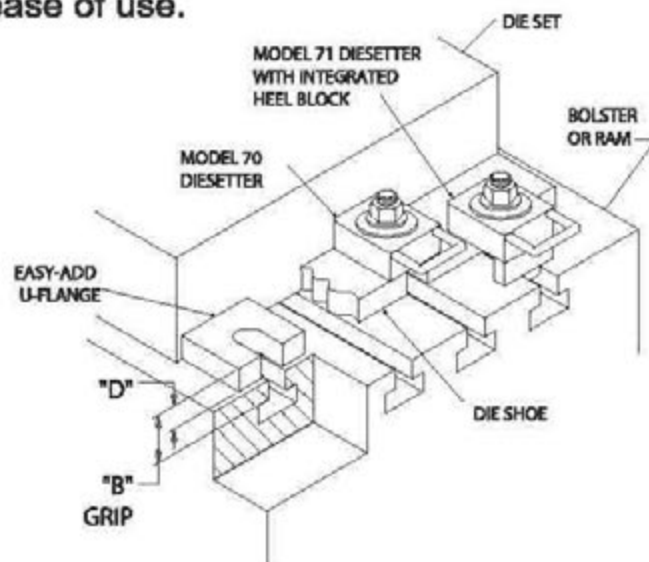

## Ordering Information

**Step 1: Select Model Number** - Model 70 without heel or Model 71 with heel

**Step 2: Specify T-Slot Size** - 5/8", 3/4" or 1"

**Step 3: Select T-Slot Bolt Length** - Use column B of the Load and Dimensional Data chart on the following page and identify your desired min./max. total grip height. Total grip height "B" is the T-slot neck height plus the die flange thickness "D". Read across to column "A" and select T-slot bolt length.

**Step 4: Select Load Capacity** - Identify the load capacity desired for your application and select the color code associated with an equal or higher load capacity.

**Step 5: For Model 71 Only, Specify Die Grip Height** - Add exact die flange thickness to P/N, after color code

**Example 1:** Model 70-3/4-6"-Gold = Diesetter Clamp (no heel) for 3/4" T-slot, with a 6" T-bolt and load capacity of 15 tons (30,000 lbs.)

**Example 2:** Model 71-3/4-6"-Gold-1.500 = Diesetter Clamp (with heel) for 3/4" T-slot and die grip thickness of 1.5", with a 6" T-bolt and load capacity of 9 tons (18,000 lbs.)

# Diesetter™ Mechanical Clamps

Pacesetter Systems • Toll Free: 866-EZSETUP • www.pacesettersystems.com

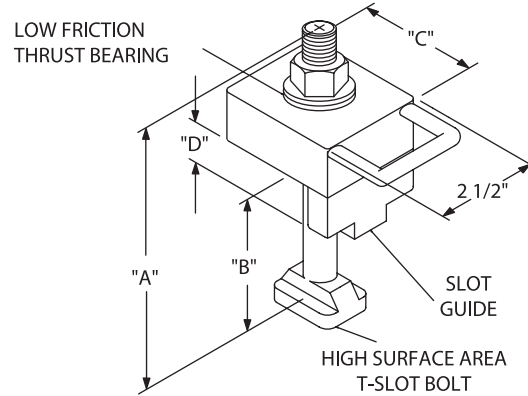
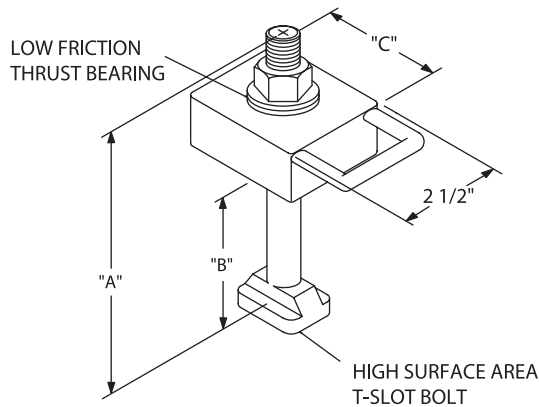

## Load and Dimensional Data

T-Slot Size	Load Capacity		"A" T-Slot Bolt Length	"B" Grip Length – Total including T-Slot Throat Height		Hex Nut Size (Thread Size)	Torque Ft.-Lbs.	"C" Clamp Body Length	"D" (Mod 71 only) Height of Die Clamping Ledge
	Series	Load		Min. Grip	Max. Grip				
5/8	5/8 Gold	10 Tons *	3 1/2 4 5	.31 .31 .31	1.9 2.4 3.4	1 1/4 Hex (5/8-11 Thd.)	80	2 1/2	Specified by User
3/4	3/4 Blue	6 1/2 Tons *	4 5 6 7	0.5 0.5 1.4 2.4	1.75 2.75 3.75 4.75	1 1/4 Hex (3/4-10 Thd.)	125	3 1/2	Specified by User
3/4	3/4 Gold	15 Tons *	4 5 6 7	0.5 0.5 1.4 2.4	1.75 2.75 3.75 4.75	1 1/4 Hex (3/4-10 Thd.)	125	3 1/2	Specified by User
1"	1" Blue	8 1/2 Tons *	4 5 6 7	0.5 0.5 1.4 2.4	1.75 2.75 3.75 4.75	1 5/8 Hex (7/8-9 Thd.)	150	3 1/2	Specified by User
1"	1" Red	10 1/2 Tons *	4 5 6 7	0.5 0.5 1.4 2.4	1.75 2.75 3.75 4.75	1 5/8 Hex (1"- 8 Thd.)	150	3 1/2	Specified by User
1"	1" Gold	18 Tons *	4 5 6 7	0.5 0.5 1.4 2.4	1.75 2.75 3.75 4.75	1 5/8 Hex (7/8-9 Thd.)	150	3 1/2	Specified by User
1"	1" Green	22 Tons *	4 5 6 7	0.5 0.5 1.4 2.4	1.75 2.75 3.75 4.75	1 5/8 Hex (1"- 8 Thd.)	150	3 1/2	Specified by User

\* Load capacity of model 71 (with heel) is 60% of that shown above

## Toll Free 866-EZSETUP





**Power Pallet push/pull die loading system, for up to 6,000 lbs**

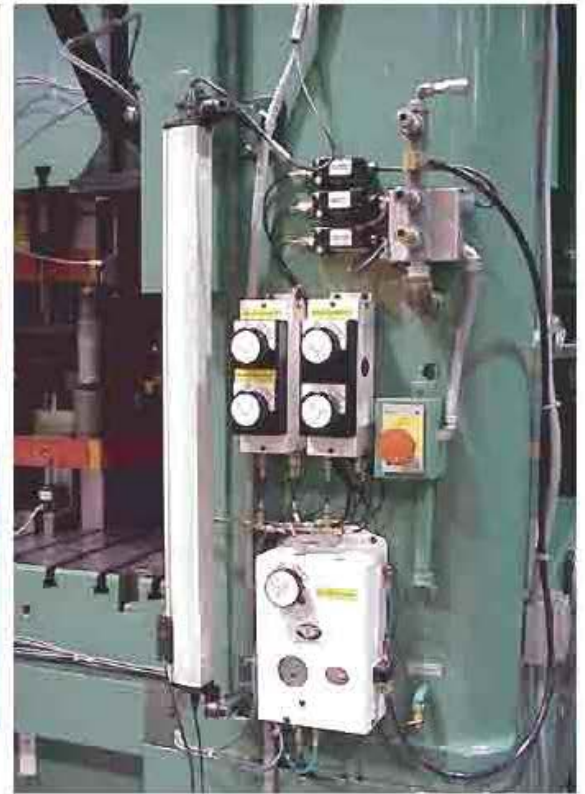

**Air-Driven Hydraulic Power Supply  
with Five-Circuit Controls**



**Complete Quick Die Change System**

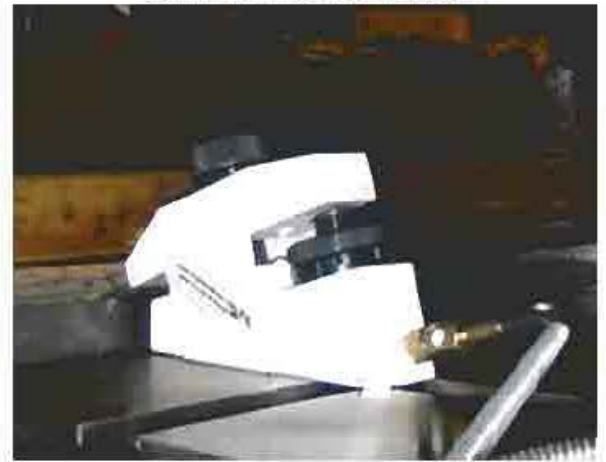

**Gorilla Grip Adjustable Hydraulic Rocker Clamp**



**Bolster Extensions Folded on Press**



**Pacesetter Signature Diesetter Clamps**